

Trail-Sport

BY R-VISION



The Lite Side of Camping



MODEL TS23FDS
Interior Decor - Baymont Salsa



Travel Trailers

▼ Pass-Thru Storage

TS20RD

NEW!

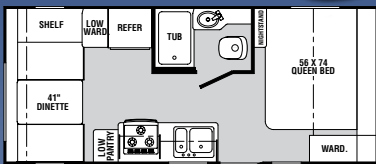

TS23FDS

NEW!

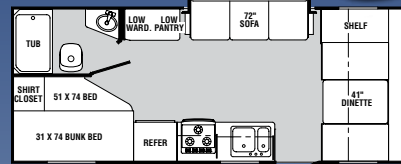

TS27FQ

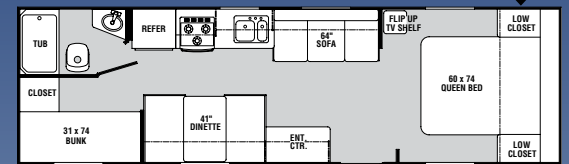

TS21RBH

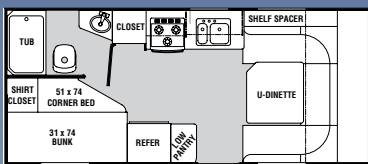

TS24BH

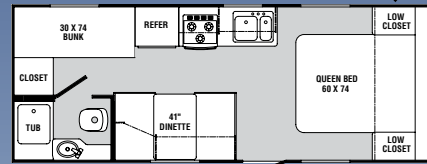

TS27QBSS

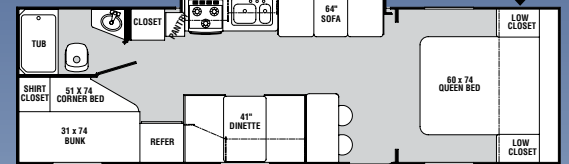

TS22QB

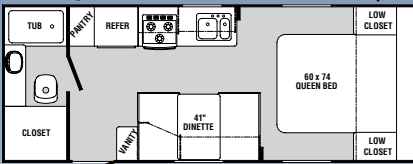

TS25S

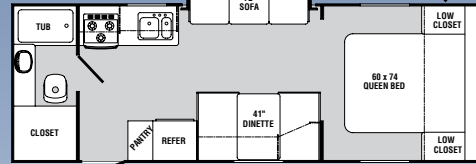

TS29BHSS

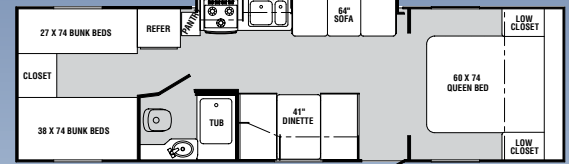

Expandables

TSE191

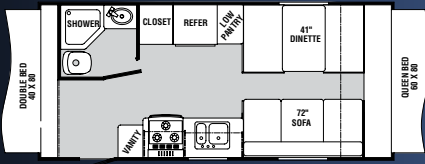

TSE21RBH

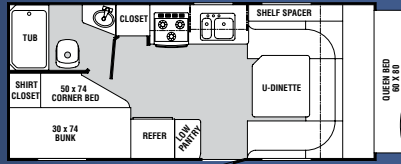

TSE233

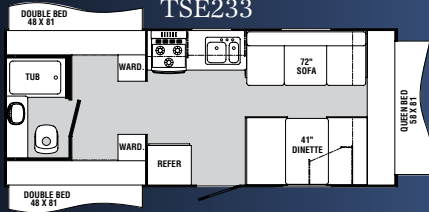

Expandables	TSE191	TSE21RBH	TSE233
Length	21' 10"	22' 5"	23' 9"
Width (w/o Awning)	96"	96"	96"
Height (w/AC)	9' 9"	9' 9"	9' 9"
Load Cap.	2888	3028	2662
*Hitch Dry Wt. (Appr.)	381	393	460
*Axle Dry Wt. (Appr.)	2712	2572	2938
*Total Dry Wt.	3093	2965	3398
GVWR	5981	5993	6060
Fresh Water Tank Cap.	30	30	30
Grey Water Cap.	30	30	30
Black Water Cap.	30	30	30
Tire Size	ST205/ 75R14C	ST205/ 75R14C	ST205/ 75R14C

* Weights are approximate and based on standard features, optional equipment not included.

Easy as a breeze to tow, the Trail-Sport is loaded with special features designed for family camping. These lightweight aluminum framed travel trailers are built with exceptional durability to deliver long-term enjoyment and value.



MODEL TS29BHSS
Interior Decor - Moss

Travel Trailers	TS20RD	TS21RBH	TS22QB	TS23FDS	TS24BH	TS25S	TS27FQ	TS27QBSS	TS29BHSS
Length	22' 11"	22' 5"	24' 10"	24' 4"	25' 6"	27' 10"	31' 7"	31' 8"	32' 4"
Width (w/o Awning)	96"	96"	96"	96"	96"	96"	96"	96"	96"
Height (w/AC)	9' 9"	9' 9"	9' 9"	9' 9"	9' 9"	9' 9"	9' 9"	9' 9"	9' 9"
Load Cap.	TBD	3048	2840	2690	2664	2332	2220	1792	1796
*Hitch Dry Wt. (Appr.)	TBD	351	420	410	321	280	326	393	362
*Axle Dry Wt. (Appr.)	TBD	2552	2760	2910	2936	3268	3380	3808	3804
*Total Dry Wt.	TBD	2903	3180	3320	3257	3548	3706	4201	4166
GVWR	TBD	5951	5999	6010	5921	5880	5926	5993	5962
Fresh Water Tank Cap.	30	30	30	30	30	30	30	30	30
Grey Water Cap.	30	30	30	30	30	30	30	30	30
Black Water Cap.	30	30	30	30	30	30	30	30	30
Tire Size	ST205/ 75R14C	ST205/ 75R14C	ST205/ 75R14C	ST205/ 75R14C	ST205/ 75R14C	ST205/ 75R14C	ST205/ 75R14C	ST205/ 75R14C	ST205/ 75R14C

* Weights are approximate and based on standard features, optional equipment not included.

Standards & Options

Appliances/Equipment

- 3 Burner Range Top
- Power Range Hood with Light
- Six Gallon Gas Water Heater
- 20,000 BTU Furnace
- Demand Water Pump
- Laminated Countertops
- Double Bowl Kitchen Sink
- Water Heater Bypass Kit

Electrical

- Patio Light with Amber Lens
- Ceiling Lights
- 120 Volt GFI Protected Circuit(s)
- 120 Volt Breaker Panel
- Outside 120 Volt Receptacle
- 55 Amp Converter with Charger
- Battery Rack
- Pre-Wired for Microwave
- Detachable 30 Amp Power Cord

Exterior

- Powder Coated Chassis
- Radius Windows
- Radius Entry Door with Window, Deadbolt Lock and Screen Door

- Outside Storage Compartment
- Self-Storing Step
- Rotocast Holding Tanks
- Rotocast Fresh Water Tank
- 20# LP Tanks
- 2-5/16" Coupler
- Radius Baggage Door

Interior

- Galley Window
- Vinyl Back Dinette and Bunk Cushions
- Bath Sky Lights
- Valances
- Mini Blinds
- No-Wax Vinyl Flooring
- Roof Vent in Living Area (Deleted with Optional Air Conditioning Some Models)
- Power Roof Vent in Bath
- Interior Lighting Switch

Bed Ends

- Tent (Attached Inside C-channel to Prevent Water Entry)
- Continuous Piano Hinge for Added Strength
- Key Locked for Security

- Compression Clamps Ensure Tight Bond of Bunk Seals
- 6" Bunk End Cushions for Comfort
- Pre-Wired for Bunk Lights

Running Gear

- 14" Trailer Tires
- White Spoked Wheels
- Tandem Axles
- 10" Electric Brakes, All Wheels
- Galvanized Wheel Wells
- E-Z Lube Hubs

Safety

- Break-A-Way Switch
- Fire Extinguisher
- Smoke Detector
- LP Detector
- Safety Chains
- Ground Fault Protected Circuit(s)
- Dead Bolt Door Lock

General Warranty Information

- Rubber Roof 12 Yrs.
- Fiberglass Skin 2 Yrs.
- Chassis 2 Yrs.
- Lamination 2 Yrs.
- Suspension System 2 Yrs.
- General Camper Coverage 1 Yr.
- Norco Slideout Mechanism 2 Yrs.
- Atwood Appliances 2 Yrs.
- Norcold Appliances 2 Yrs.

Options

- Air Conditioning, 13,500 BTU
- Air Conditioning, 15,000 BTU
- AM/FM CD Player
- Awning
- Microwave
- Oven
- Spare Tire & Wheel
- Stabilizer Jacks - Four (Std. on Expandables)
- TV Antenna/Cable
- Roof Ladder
- Outside Grill
- Outside Shower
- Outside Sliding Drawer
- Sink Cover
- Stove Cover
- Tub Surround
- Double Entry Step
- Chrome Trim Rings w/Cap
- Fan-Tastic Fan
- Equal Flex Suspension
- 15" LCD TV with DVD
- Bar Stools (TS27QBSS)
- DSI Water Heater
- Tinted Safety Glass
- 2 Door Refrigerator

Construction Features

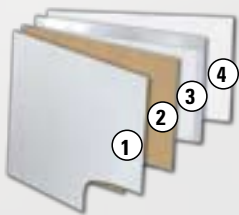

Sidewall Laminate

1. Fiberglass Skin - dent resistant, low maintenance
2. Lauan
3. Aluminum Frame and Foam
4. Wallboard



Floor Laminate

1. Lauan
2. Lauan
3. Aluminum Frame and Foam
4. Lauan
5. Darco

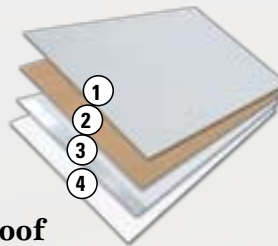

Roof Laminate

1. Rubber Roof
2. Lauan
3. Aluminum Frame and Foam
4. Ceiling Board

R-Vision Exclusive

Free Standing
RVQ Grill



Your Dealer

R-Vision, Inc.
2666 S. Country Club Drive
Warsaw, IN 46580
574.268.2111
www.trail-lite.com

As R-Vision constantly strives to improve our product, all specifications listed in this informative brochure are subject to change without notice or obligation. Photos may show optional equipment which is not included in the purchase price of the unit. Test drive and review a current model on your dealer's lot today.
R-80-099 2007 R-Vision, Inc. Litho U.S.A.