

PULSE

2019 FLEETWOOD RV CLASS C DIESEL

TOP FEATURES

- Full body paint
- 15,000 BTU air conditioner w/heat pump
- 1000W Inverter
- Garmin™ Infotainment dash unit with navigation (RV Maps)
- Solid surface galley countertops w/undermount stonecast sink and cover
- LED lighting
- Stainless steel appliances
- Whole house water filtration
- One-piece TPO roof
- 2" thick sidewalls
- Power lateral arm awning with LED lighting and motion sensor
- Stabilizing jacks
- Lighted storage compartments
- RDQ easy access winterization system
- Rotocast exterior storage compartments
- All metal underbelly
- Interlocking sidewalls and roof construction
- 5,000 lb. hitch

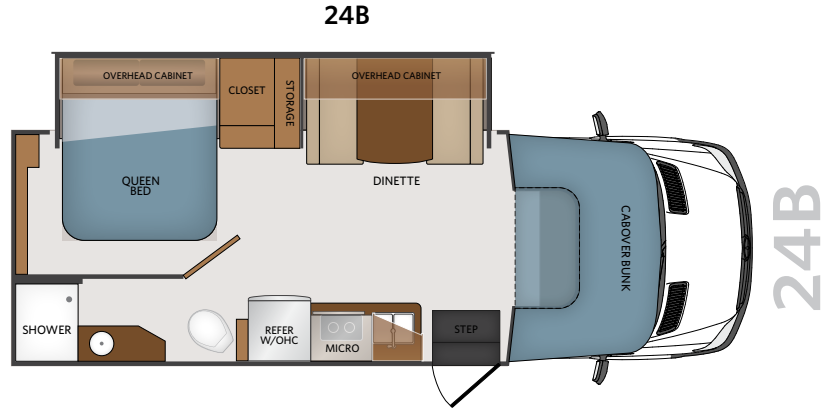
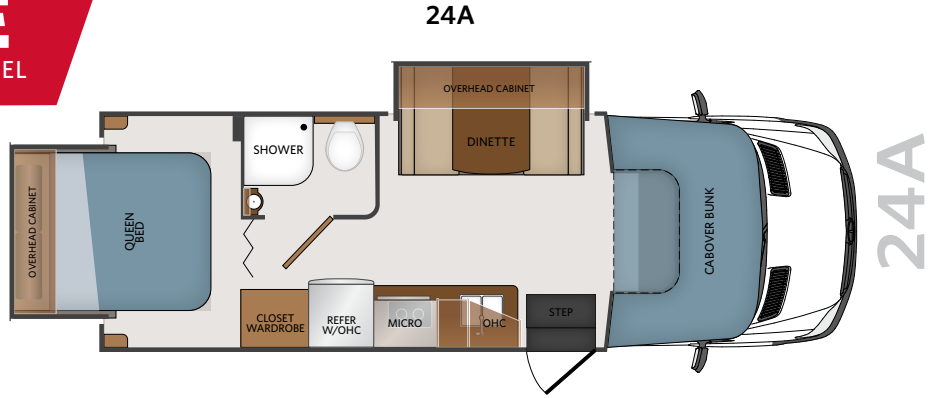

CHASSIS

MODEL	24A	24B
Wheelbase (inches)	170"	170"
Front GAWR (lbs)	4,410	4,410
Rear GAWR (lbs)	7,720	7,720
GCWR (lbs)	15,250	15,250
GVWR (lbs)	11,030	11,030
Hitch Rating Weight (lbs)	5,000	5,000
Tongue Weight (lbs)	500	500
Fuel Capacity (gal)	26.4	26.4

DIMENSIONS AND CAPACITIES

MODEL	28A	29M
Overall Length (inches)	25' 2"	25' 2"
Overall Height (with A/C)	11' 4"	11' 4"
Overall Width (maximum)	7' 8"	7' 8"
Interior Height (maximum)	82"	82"
Interior Width (maximum)	88"	88"
Patio Awning Width (feet & inches)	15' 6"	15' 6"
Interior Storage (cu. ft.)	24	24
Exterior Storage (cu. ft.)	42	40
Fresh Water Holding Tank (gal)	29	29
Grey Water Holding Tank (gal)	33	33
Black Water Holding Tank (gal)	33	33
Appliance Propane Tank (gal.) (WC)	13	13
Water Heater Tank (gal)	6	6

MERCEDES-BENZ CHASSIS

Model: Mercedes Benz Sprinter
 Engine: 3.0L Cylinder, 188HP, Turbo-Diesel Engine
 Transmission: Mercedes-Benz, 5-Speed, Automatic
 Alternator: 220 Amp
 Torque: 325 lb.-ft. @ 1,400 RPM
 Horsepower: 188HP @ 3,800 RPM

EXTERIOR CHOICES



STARLIGHT



RESORT

CONTACT US To locate a dealer near you, visit our website at www.fleetwoodrv.com or call 1-877-252-4666.

We can also be contacted at Fleetwood RV Customer Relations, P.O. Box 1007, Decatur, IN 46733.

©2019 REV GROUP

Printed in USA. 08/18. Model Year 2019. Second Edition.