



FR3

BY FOREST RIVER

Cross Over Motorhome

SPECIFICATIONS

	29DS	30DS	32DS
Chassis	Ford	Ford	Ford
Engine	V-10	V-10	V-10
Horsepower	320 HP	320 HP	320 HP
Torque	460 ft-lbs	460 ft-lbs	460 ft-lbs
Wheelbase	190"	190"	228"
Fuel Capacity	80 gal	80 gal	80 gal
Tire Size	245/70R19.5	245/70R19.5	245/70R19.5
GVWR	18,000 lbs	18,000 lbs	20,500 lbs
GCWR	23,000 lbs	23,000 lbs	26,000 lbs
GAWR Front	7,000 lbs	7,000 lbs	7,500 lbs
GAWR Rear	12,000 lbs	12,000 lbs	13,500 lbs
Exterior Storage	115 cu ft	112 cu ft	116 cu ft
Safety Belts	6	8	8
LP Tank	24.5 gal	24.5 gal	24.5 gal
Water Heater	6 gal	6 gal	6 gal
Furnace	35,000 BTU	35,000 BTU	35,000 BTU
Fresh Water	50 gal	50 gal	50 gal
Grey Tank	42 gal	42 gal	42 gal
Black Tank	42 gal	42 gal	42 gal
Length	30' 9"	31' 8"	33' 11"
Exterior Width	99.5"	99.5"	99.5"
Exterior Height w/A/C	12' 3"	12' 3"	12' 5"
Interior Width	95.5"	95.5"	95.5"
Interior Height	82"	82"	82"
Awning Length	20'	16'	12'

GVWR (Gross Vehicle Weight Rating) is the maximum permissible weight of the unit when fully loaded. It includes all weights, inclusive of all fluids, occupants, cargo, optional equipment and accessories. For safety and product performance do NOT exceed the GVWR.

GCWR (Gross Combined Weight Rating) is the maximum permissible loaded weight of your motor home and any towed trailer or towed vehicle. Actual GCWR of this vehicle may be limited by the sum of the GVWR and the installed hitch receiver maximum capacity rating; see hitch rating label for detail.

GAWR (Gross Axle Weight Rating) is the maximum permissible weight, including cargo, fluids, optional equipment and accessories that can be safely supported by each axle.

UVW (Unloaded Vehicle Weight)* is the typical weight of the unit as manufactured at the factory. It includes all weight at the unit's axle(s), including full fuel, all fluids and LP Gas. The UVW does not include cargo, fresh potable water, additional optional equipment or dealer installed accessories.

*Estimated Average based on standard build optional equipment.

CCC (Cargo Carrying Capacity)** is the amount of weight available for fresh potable water, cargo, passengers, additional optional equipment and accessories. CCC is equal to GVWR minus UVW. Available CCC should accommodate fresh potable water (8.3 lbs per gallon). Before filling the fresh water tank, empty the black and gray tanks to provide for more cargo capacity.

** Estimated average based on standard build optional equipment

Each Forest River RV is weighed at the manufacturing facility prior to shipping. A label identifying the unloaded vehicle weight of the actual unit and the cargo carrying capacity is applied to every Forest River RV prior to leaving our facilities.

The load capacity of your unit is designated by weight, not by volume, so you cannot necessarily use all available space when loading your unit.

Actual towing capacity is dependent upon your particular loading and towing circumstances, which includes the GVWR, GAWR and GCWR as well as adequate trailer brakes. Please refer to the Operator's Manual of your vehicle for further towing information.

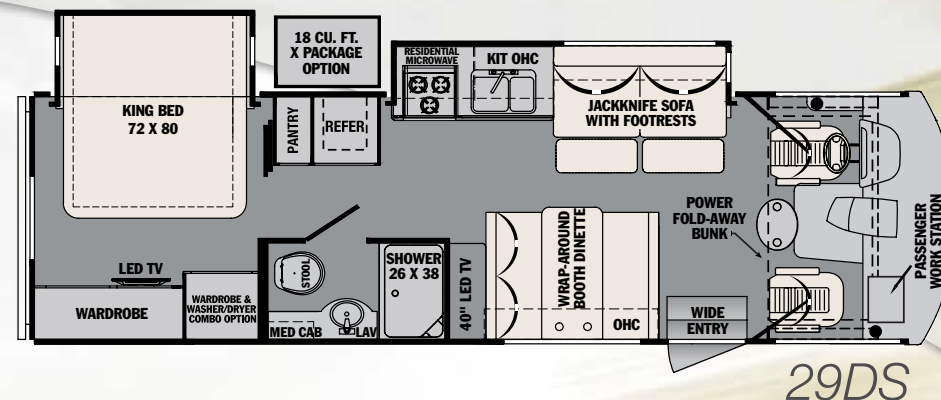

29DS

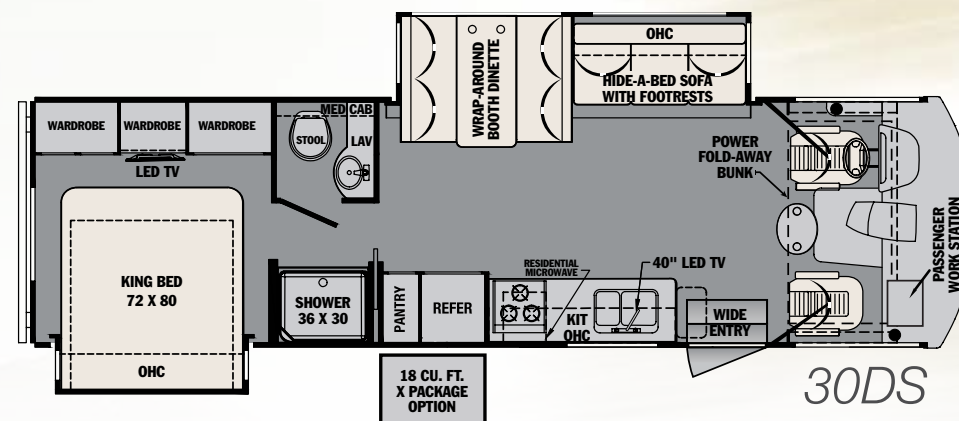

30DS

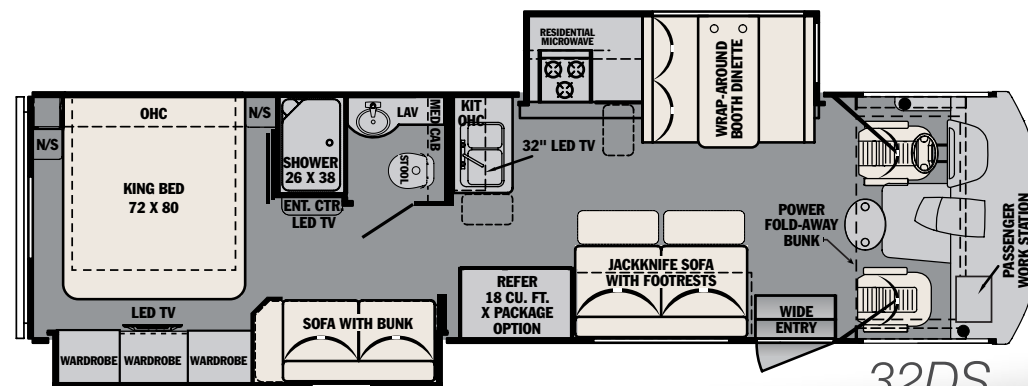

32DS

FEATURES, STANDARDS & OPTIONS

Construction & Exterior

White Diamond Pearl Gel-Coat Sidewalls
w/ Graphics
One Piece Fiberglass Roof
Fiberglass Front Cap
Bi Hi/Lo Headlights
LED Turn Signals
Side-swing Front Grill w/ Mesh Bug Shield
Lower Fog Lights w/ LED Accents
Color Side and Rear Camera Package
"SUPER STORAGE" Rear Cargo Compartment
Rotocast Storage Boxes w/ Drains
Rear Roof Ladder
Encased Power Patio Awning w/ LED Light
Slideout Room Awning(s)
Rubber Tread Entry Steps
Outside Shower
Electric Entrance Step
Rubberized Entry Assist Handle
Vacuum Bonded Construction
Steel Front Cockpit Cage
Hydraulic 4-Point Leveling Jacks
Outside Entertainment Center
w/ TV and Marine-Grade Speakers
Quick Connect Exterior LP Fitting

Chassis & Cockpit

Molded ABS Automotive Dash
w/ Laptop Console and 110V Outlet
Power Front Sun Shade
Ultra Leather Driver/Passenger Seating
w/ Double Stitching
Low Profile Cockpit Engine Cover
Pioneer Dash Entertainment System
w/ AM/FM/CD/DVD/Bluetooth/Backup
Color Monitor/USB and Sound Selector
(Mirror Link Navigation Available with
Most Smart Phones)
5,000 lb. Tow Hitch w/ 7-Way Plug
Automotive Style Bonded One Piece
Windshield w/ Backlit Logo
Power Heated Exterior Mirrors
Driver/Passenger LED Map Lights
Diamond Plate Rubber Floor Covering
(driver area)

Interior

Entry Assist Handle
Power Front Fold-Away Overhead Bunk
w/ Ladder
40" LED TV (29DS, 30DS)
32" LED TV (32DS)
KING Jack™ Digital TV Antenna
w/ Mount and Built-in Signal Meter
Residential Interior Ceiling
Shaw Residential Vinyl Flooring
Brushed Nickel Hardware
and Plumbing Fixtures
Ultra Leather Sofa w/ Dual Footrests
(Hide-a-Bed 30DS only)
Ultra Leather Wrap Around Dinette Booth
w/ Comfort Cushions
Heavy Duty Full Extension Drawer Guides
Night Shades Throughout
LED Lighting Throughout

Galley

Double Door 6 cu. ft. Gas/Electric
Refrigerator
3-Burner Cooktop w/ Oven and Flush Mount
Stove Cover
Flip-up Countertop Extension (30DS, 32DS)
Residential Microwave Oven
Large Double Bowl Stainless Steel Sink
and Faucet
Custom Countertops
Trash Can Storage Area Below Sink
12 Volt Charging Station

Bedroom & Bathroom

72" x 80" Residential King Bed
Bedroom Wardrobe
Toilet with Foot Flush
Stainless Steel Lavatory Sink and Fixture
Brushed Nickel Framed Glass Shower
Washer Dryer Combo Prep (29DS)

Safety & Convenience

Extra Wide Entry Door w/ Deadbolt Lock
Forest River Command Center

Carbon Monoxide and LP Detectors
Smoke Alarm
Fire Extinguisher

Electrical & Plumbing

4.0 KW Onan Generator (N/A 32DS)
High Output Quiet Air Command™ Ducted
Roof A/C w/ Chill Construction
and Heat Pump
2 Deep Cycle House Batteries
Battery Disconnect Switch
Emergency Start Switch
Shore Power Electrical Cord
w/ Storage Compartment
6 Gallon Gas/Electric Water Heater
Arctic Pack System (Heated Holding Tanks)
Black Water Tank Flush
35,000 BTU Furnace

Decor

Oakley Seal
Pebble

Cabinetry

Raised Panel FR3 Custom Wood Cherry

Options

X Package (mandatory on 32DS)
50 Amp Service
5.5 KW Onan Generator
2nd A/C
18 cu. ft. Gas/Electric Refrigerator

YOUR FR3 DEALER

FR3
BY FOREST RIVER



www.ForestRiverBuyLocal.com

For more information visit
www.forestriverinc.com/fr3

Forest River, Inc.
FR3 Division
902 County Road 1
Elkhart, IN 46515
(574) 367.3285



Learn More
Scan this barcode using
a QR Reader on your
smart phone to learn
more about Forest River.



A Berkshire Hathaway company.

All information contained in this brochure is believed to be accurate at the time of publication. However, during the model year, it may be necessary to make revisions and Forest River, Inc., reserves the right to make all such changes without notice, including prices, colors, materials, equipment and specifications as well as the addition of new models and the discontinuance of models shown in this brochure. Therefore, please consult with your Forest River, Inc., dealer and confirm the existence of any materials, design or specifications that are material to your purchase decision. 12/17

©2017 FR3

a Division of Forest River, Inc., a Berkshire Hathaway company. All Rights Reserved.