

# Pursuit

## Precision

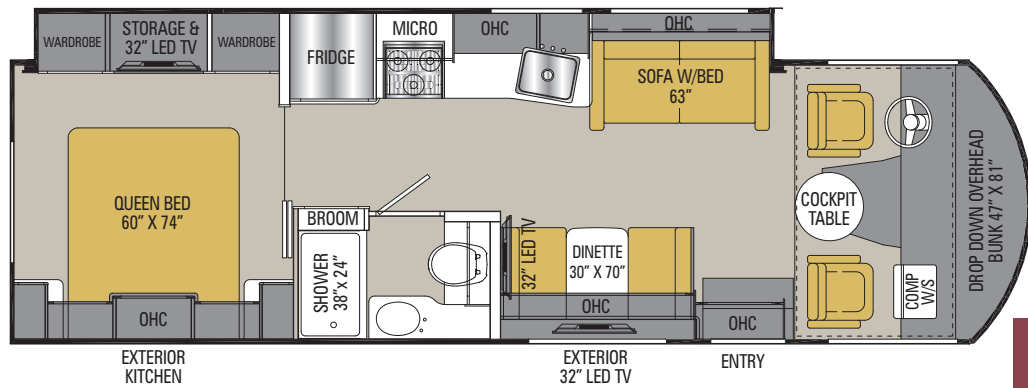

**29SS**

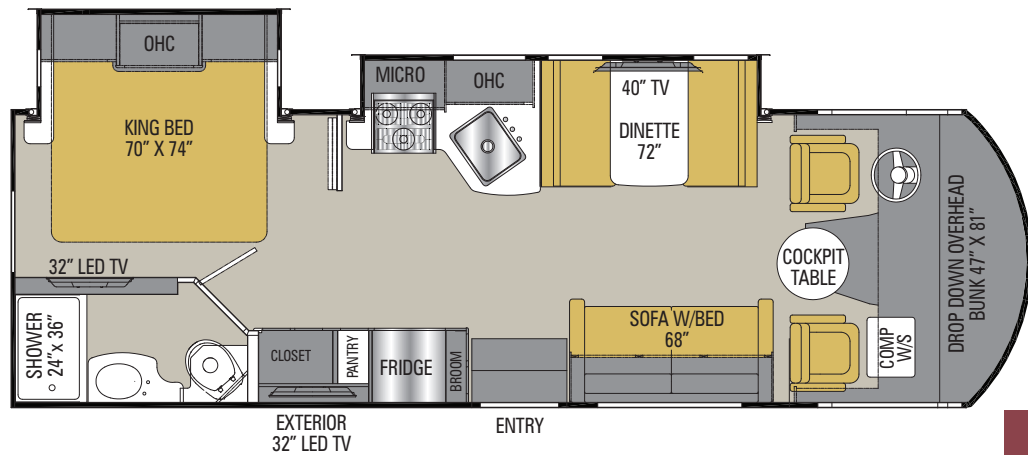

**27DS**

# STANDARD FEATURES

## INTERIOR APPOINTMENTS

Power Drop-Down Front Bunk  
 Self Closing Ball Bearing Drawer Guides Throughout  
 Thermofoil countertops throughout  
 Beau Flor  
 High Gloss wood Grain  
 Brushed Nickel Hardware  
 Hardwood Cab Doors / flat panel  
 Frameless Tinted Windows w/ Safety Glass  
 Lower Floor & Upper Entrance Door Safety Windows  
 Reclining / Swivel Pilot Seats  
 Soft Touch Jackknife Sofa  
 Privacy Roller Shades Coach  
 Dream Booth Dinette  
 Round Cockpit Pedestal Table  
 Easy Clean Cockpit floor

## INTERIOR EQUIPMENT

Radio AM/FM/Blue Tooth  
 Satellite Prep wire to roof  
 Exterior Cable TV Jack  
 LP Leak Alarm and Smoke Detector  
 Carbon Monoxide Detector  
 Fire Extinguisher  
 King Jack TV Antenna  
 32" LED TV Coach  
 DVD Player in Living room  
 Broom Closet  
 Mud Room at Stepwell  
 Charging Station for Electronic Devices  
 Bedroom Radio AM/FM/Blue Tooth w/ Outside Speakers  
 Fantastic Vent W/ Shroud in Bedroom & Coach (27SD)  
 Fantastic Vent W/ Shroud in Coach (29SS)

## GALLEY

Range Hood W/ Light  
 Flush Mount, Double Door Refer  
 High Rise Kitchen Faucet  
 Stainless Steel Kitchen Sink  
 3-Burner Range  
 Microwave Oven  
 Tile Backsplash  
 Range Cover  
 Trash Can

## SLEEPING

Queen Bed 60W X 75L (29SS)  
 King Bed 72W X 76L (27DS)  
 Serta Mattress (29SS)  
 Denver Mattress (27DS)  
 Designer Headboard  
 32" LED TV Bedroom

## BATH AND WATER

Porcelain Toilet w/Foot Flush  
 One Piece ABS shower Surround  
 Upgrade Shower Curtain  
 Power Bath Vent  
 6-Gallon (Gas/ELEC) D.S.I. Water Heater  
 Demand Water Pump  
 Skylight Over the Shower  
 Stainless Lav Sink  
 Outside Shower  
 Black Tank Flush

## ELECTRICAL//HEATING/AC

### 29SS

50 Amp Package (includes)  
 50 Amp Power Cord  
 5.5 KW Onan Generator  
 Two 13,500 BTU Air Conditioner Ducted

### 27DS

30Amp Package (includes)  
 30' -30amp Power Cord  
 4.0 Generator Onan Generator  
 One 15,000 BTU Air Conditioner Ducted

Automatic Transfer Switch  
 55 amp Converter w/ Distribution Panel  
 GFI Circuit  
 Outside Receipt  
 Emergency Start Switch  
 30,000 BTU E.I. Furnace  
 Duel 12V Coach Batteries  
 Coach Command Center  
 Heated Holding Tank Compartment  
 LED Interior Lights  
**Exterior Kitchen Includes: (29SS)**  
 Refrigerator, Sink & Portable Gas Grill, Gas Grill  
 Stand & Propane Hose & Hook-Up

## AUTOMOTIVE/EXTERIOR

Travel Easy Roadside Assistance (Coach-Net)  
 18,000# Ford Chassis (29SS)  
 16,000# Ford Chassis (27DS)  
 Computer Work Station W/USB,12V,120V  
 Tilt Steering Wheel  
 Cruise Control  
 Intermittent Wipers  
 Dash Air Conditioning  
 Cab Privacy Shades  
 Back Up Monitor w/Side Cameras  
 Radial Tires  
 Rear Mud Flaps Only  
 Power Entrance Step-Single  
 Crowned, Laminated TPO Roof  
 Radius Trunk Doors  
 Fiberglass Front Cap  
 Exterior LED Strip Light  
 Dead Bolt Lock-Entrance Door  
 26" Radius Entry Door  
 Power Patio Awning  
 8,000 Towing Hitch w/ 7 Way Plug  
 Rear Mounted Roof Ladder  
 Chrome Power Heated Mirrors  
 Rear Bumper  
 Stainless Steel Wheel Liners  
 Slide-out room awning(s)  
 20 Gallon LP Tank  
 Valve stem extenders  
 Noble Select Gelcoat High Gloss Sidewalls  
 (with AZDEL SUPERLITE COMPOSITE)  
 Outside Entertainment Center w/ 32" TV & DVD  
 Automatic Leveling Jacks  
 Exterior Kitchen (29SS Only)

## Interior Decor Color Selections

Desert Spice  
 Scenic Swirl  
 Copper Penny

## Interior Wood Color Selections

Estate Cherry  
 Cappuccino Cherry

## Exterior Color Selections

Oyster Fiberglass W/ Mocha Frost Vinyl Graphics  
 Oyster Fiberglass W/ Logan Berry Vinyl Graphics

SECIFICATIONS	27DS	29SS
FORD GAS ENGINE V-10 6.8L 3-Valve	320 HP/46	TRQ 320 HP/460 TRQ
WHEEL BASE	178"	190"
GVWR	16,000 lbs.	18,000 lbs.
GCWR	23,000 lbs	23,000 lbs
FUEL CAPACITY	80 gal	80 gal
LP GAS CAPACITY (gallons)	20 gal	20 gal
FURNACE (BTUs)	30,000	30,000
EXTERIOR LENGTH (w/o ladder)	28' 9"	30' 3"
EXTERIOR HEIGHT (with AC)	12'	12'
EXTERIOR WIDTH	102"	102"
FRESH WATER	50 gal	50 gal
GREY WATER	76 gal	35 gal
BLACK WATER	38 gal	35 gal
WATER HEATER	6 gal	6 gal
AWNING SIZE	19'	20'